

# 【Event Plaza】

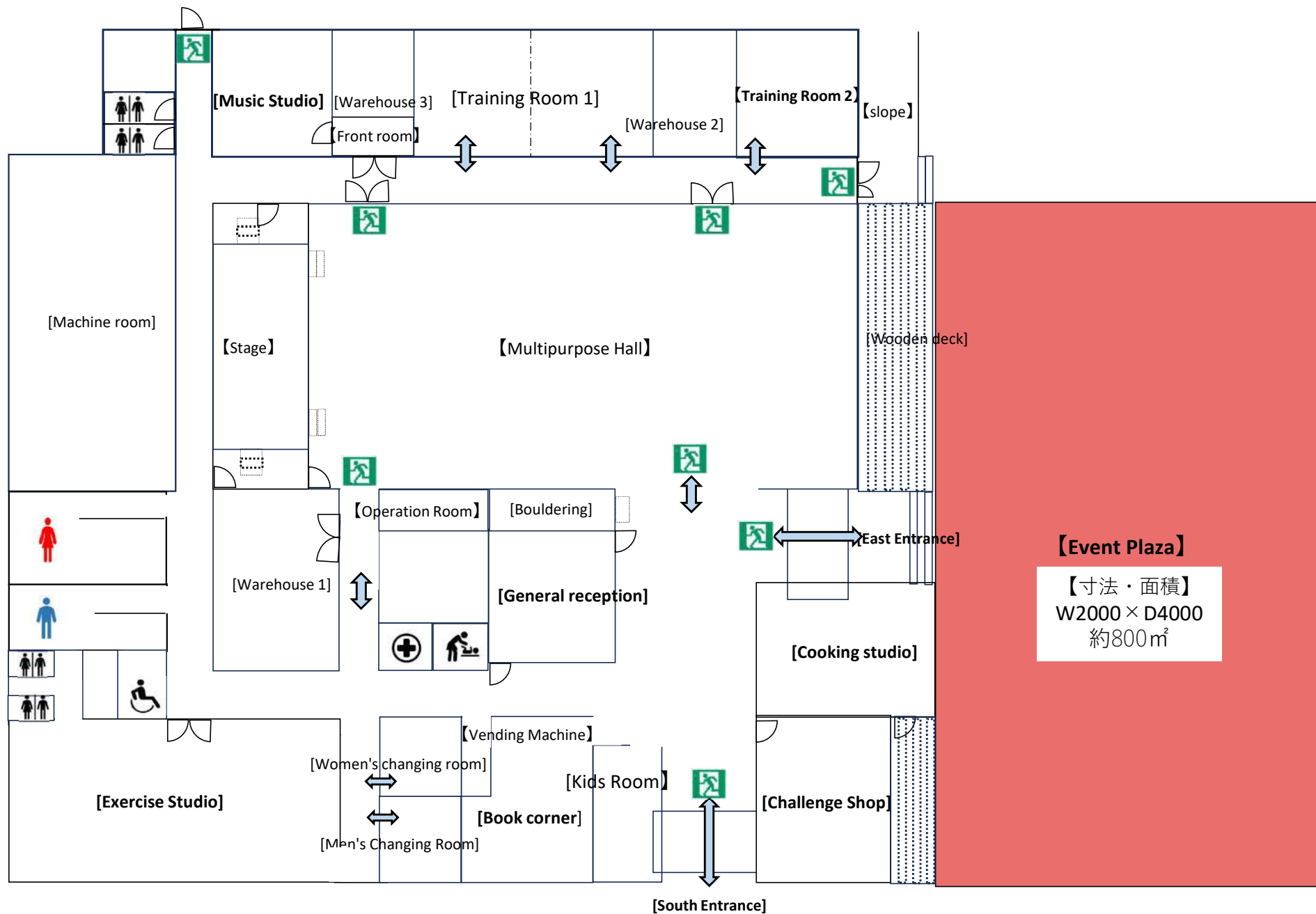



## Event Plaza

[Dimensions and area]

W2000 × D4000

Approx. 800m<sup>2</sup>

【Remarks】

Advance reservation required

- You will have exclusive use of the entire Okuma facility and the adjacent event plaza.
- linkru Okuma Indoor Wood deck is also available.

※For commercial purposes, the rate will be increased by 150% of the listed rate.

- Please make your reservation by phone or through the inquiry form.



All rooms share rental equipment	Number	Specifications and Standards
HDMI cord	3 bottles	5m × 3 bottles/15m × 1 bottle
RGB Code	2 bottles	Dsub15pin
Lan Cable	1 bottles	50m × 1 bottle
Power Extension Cord	3 bottles	3m × 1 bottle/ 5 m × 1 bottle/ 1 0 m × 1 bottle
Drum chords	1 piece	Indoor and outdoor use/length30m
HDMI→Sterminal Converter	1 bottle	5 0 (cm)
Blue Sheet	3 sheets	360 × 540 (cm) 2Sheet、 580 × 580 (cm) 1Sheet
Income Set	8 units	Microphone Wired
Laser pointer	2 units	ELP-GL09BK/Laser color green
Kurobon (Commendation basin)	2 units	W60 × D40 (cm)
Whiteboard Marker Set	2 sets	Black Pen/Red Pen/Blue Pen/Eraser
L-shaped stand	13 units	H130cm～240cm
whiteboard	4 units	wholeW180 × H190/Entry sectionW180 × H90
dresser	4 units	MirrorW45 × 155

## 【Parking details】

Total capacity of the Okuma Town Exchange Zone parking lot: 131 spaces  
Normal: 122 units, Priority: 7 units, EV fast charging: 2 units  
Reservations are required for large car parking at P4 (☎0240-23-7676)

[Click here for large vehicles](#)

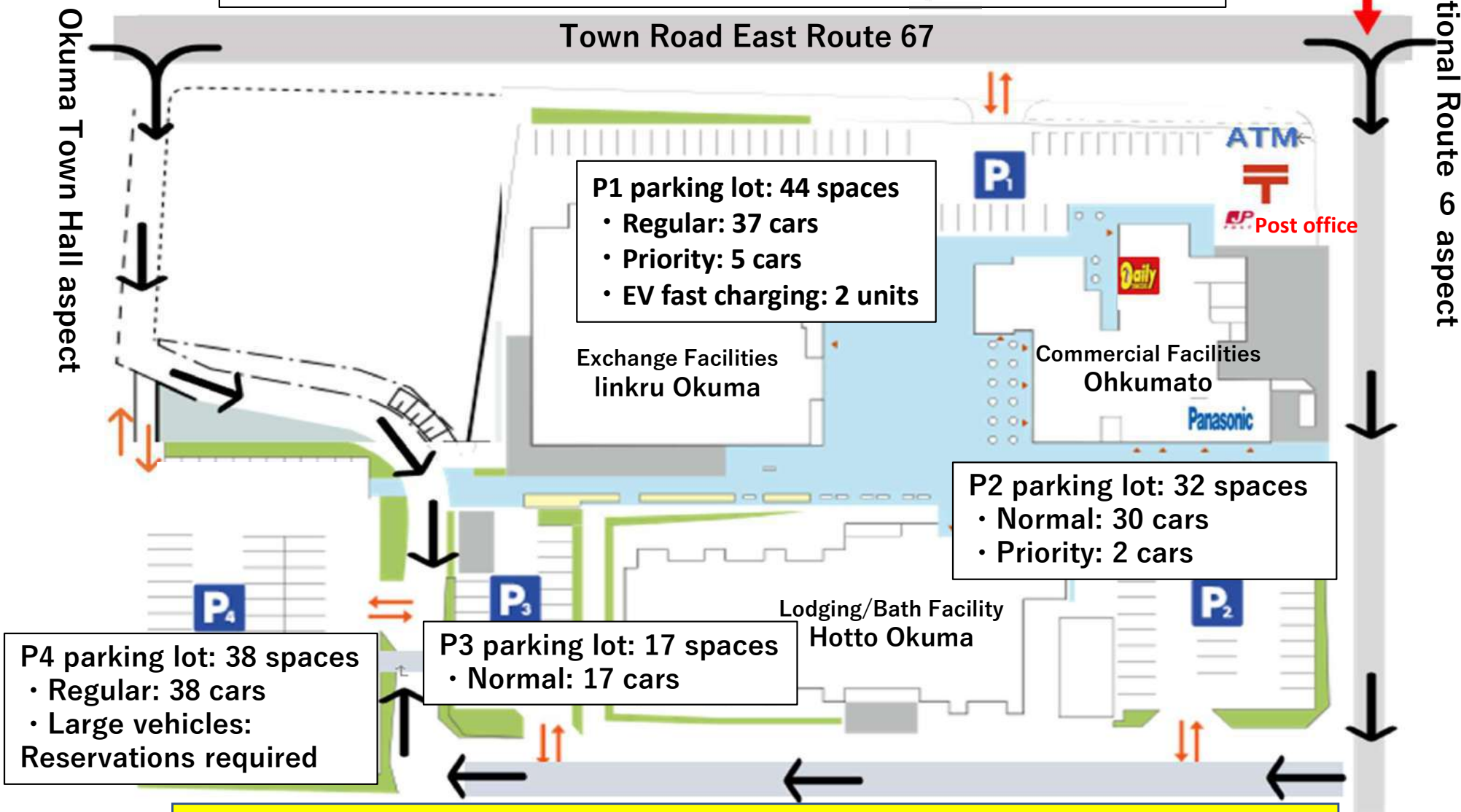

### Notes

- Parking is limited. For customers using "linkru Okuma" and "Hotto Okuma", go to "P2", "P3", and "P4". Thank you for your cooperation in parking.
- If you are coming by large vehicle such as a chartered bus, please use "P4". Please contact us in advance. In the bus space, we will install colored cones to secure the number of cars.