

Okuma Town Exchange Facility Link Materials for Okuma Organizers

table of contents

1. Table of Contents.....P1
2. Entire facility floor plan.....P2
3. Detailed information for each room.....P4
4. Multipurpose hall setup fee...P27
5. Layout example.....P28
6. General vehicle bus P4 parking lot guide map...P33

[link Okuma facility overall floor plan]

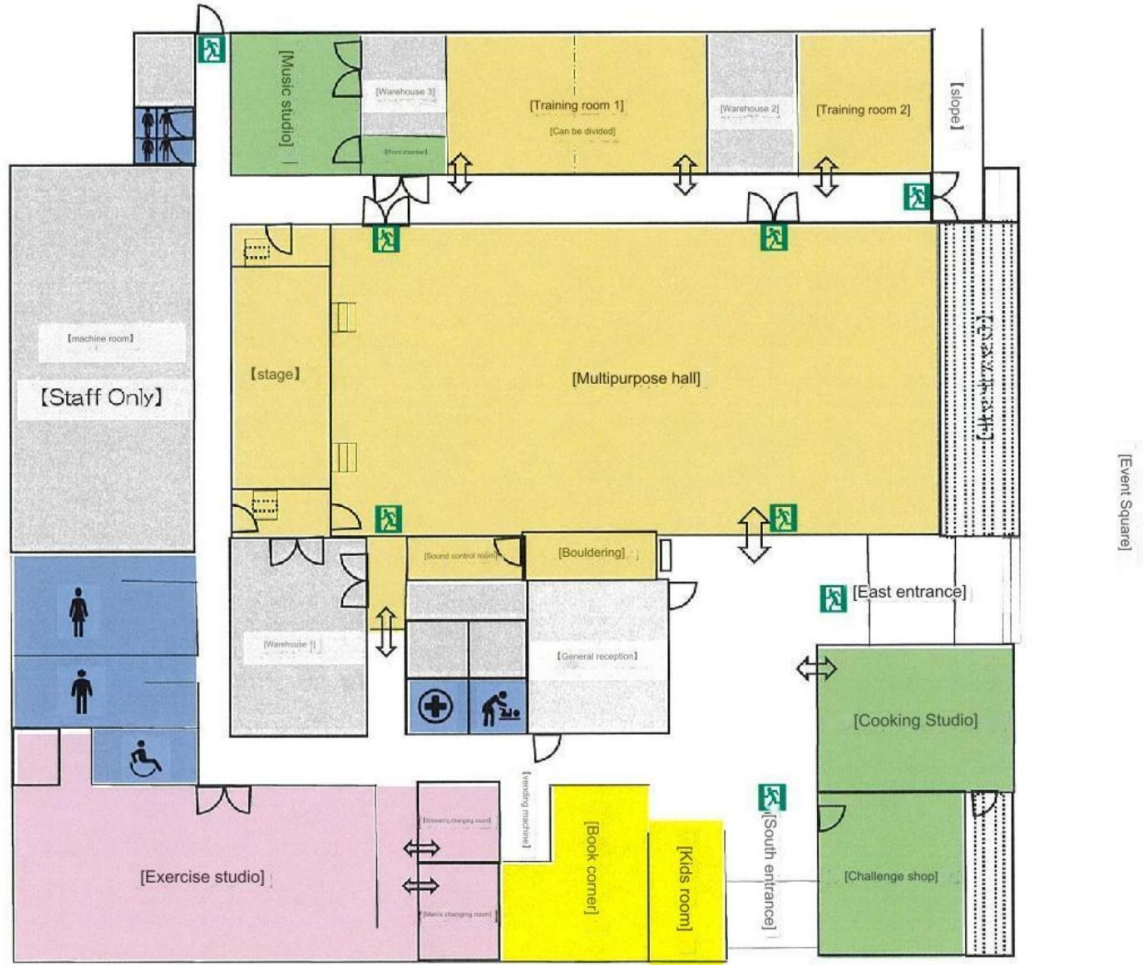

Okuma Town Exchange Facility link Ru Okuma

1207-1 Nandaira, Okawara, Okuma-machi, Futaba-gun, Fukushima 979-1306 TEL 0240-23-7676

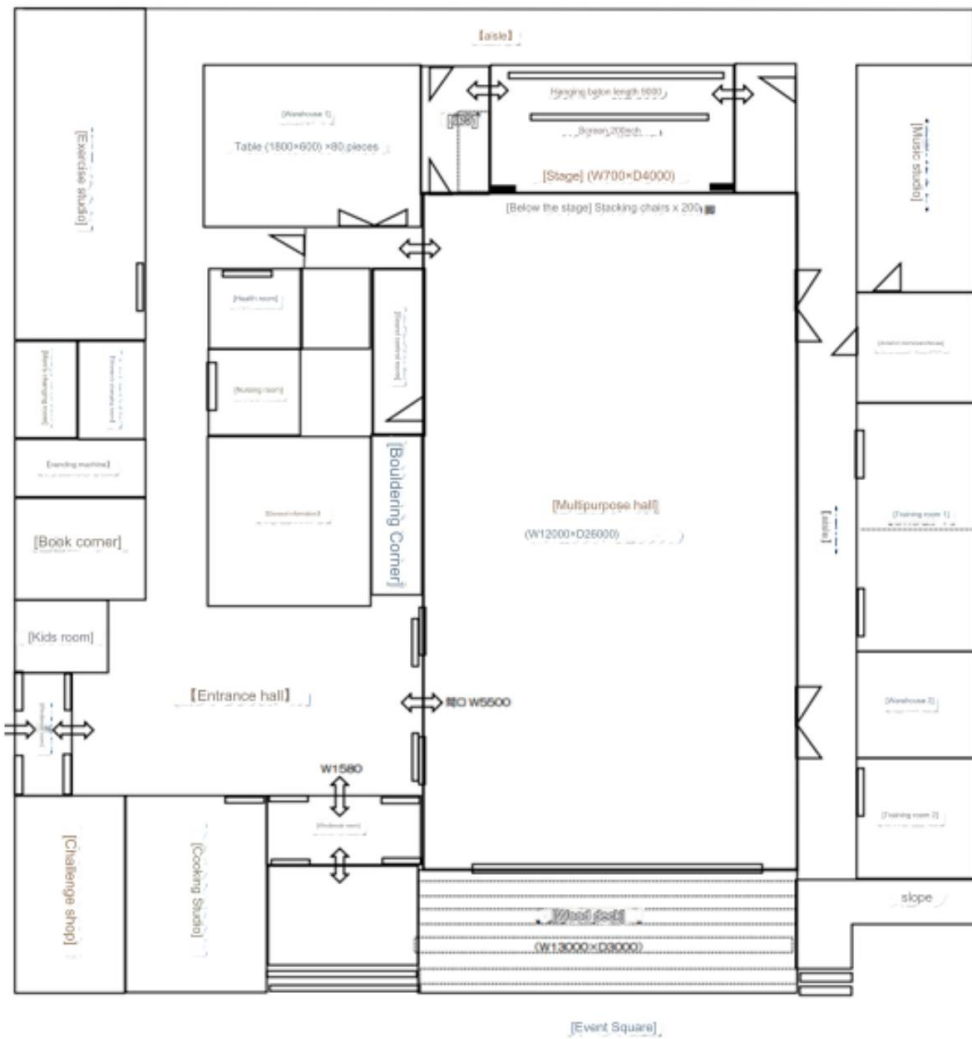

MEMO

MEMO

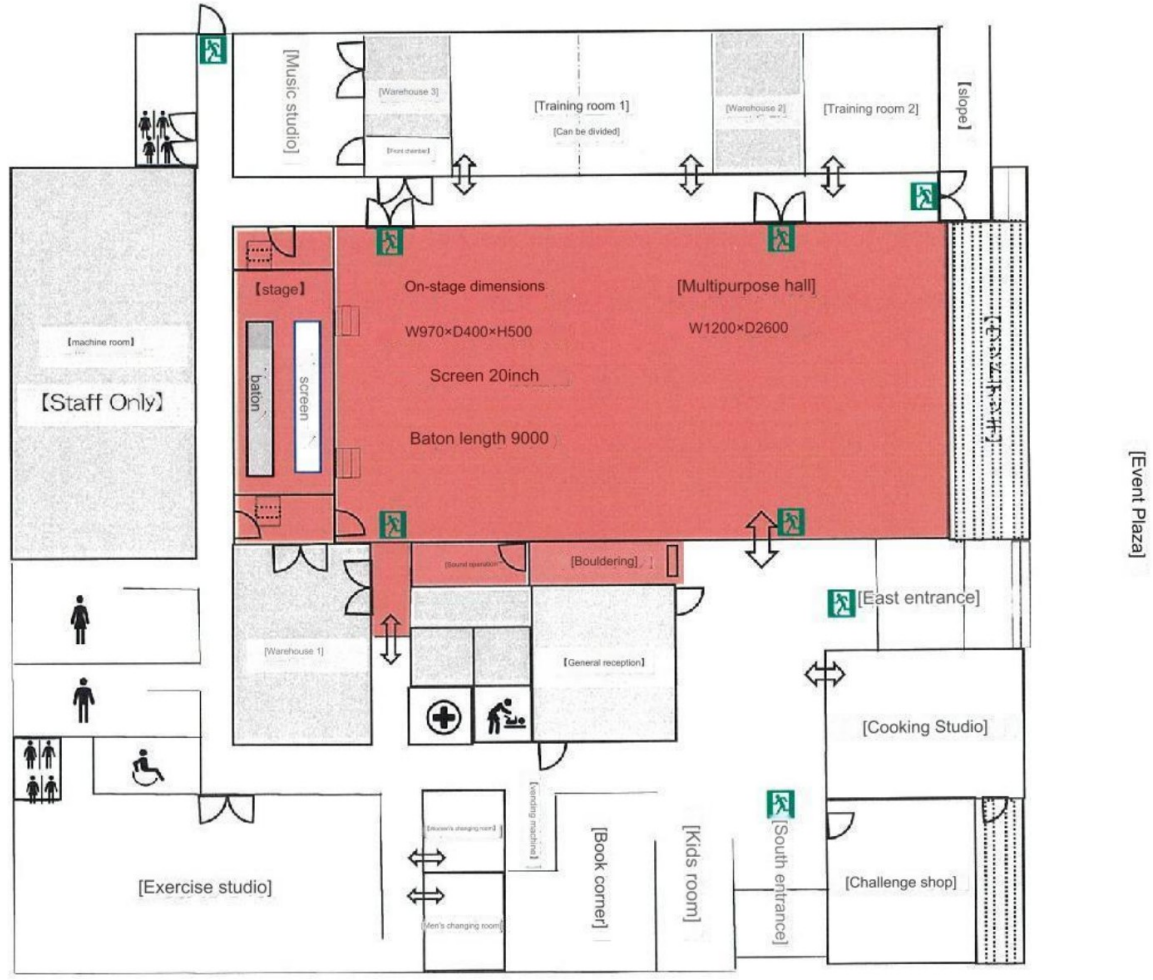

Okuma Town Exchange Facility link Ru Okuma

1207-1 Nandaira, Okawara, Okuma-machi, Futaba-gun, Fukushima 979-1306

TEL0240-23-7676



<https://goo.gl/maps/NX6h2rRdAmcB5Uo39>

Multipurpose hall

[Maximum capacity]

Theater format: 200 people

School format: 160 people

[Dimensions/area]

Inside the hall

W1200 x D2500

Approx. 300 m²

300 m² On stage

stage W1000 x D400 x H5000

Approx. 40 m²

[Note] Rental

fees for

food and drink items that are prohibited with shoes on are included.

in the usage fee. - Equipped with sound and lighting equipment, it can be used for lectures, concerts, training sessions, etc. *For commercial purposes, the fee will be increased by 150% of the

displayed price. Please contact us for details.



Equipment list/specification details

DLP projector



1 unit/Panasonic/PT-RZ970J/10,000lm
Multipurpose hall

side fold table



80 chairs/no curtain board W180xD60xH70
Multipurpose hall

stacking chair



210 spaces (150 under stage, 30 moving tables x 2)
Multipurpose hall

slipper



210 pairs
Pre-application for specifications Multi-purpose hall

screen



1 piece/200inch
multipurpose hall

partition



4 units maximum W300 x H170
Multipurpose hall

lectern



1 unit W120xD60xH100
Multipurpose hall

moderator's table



1 unit W60xD50xH100
Multipurpose hall

wireless microphone



2 units/Panasonic WX-ST200
Multipurpose hall

wireless microphone



4 pieces/Panasonic WMD170SW-K
Multipurpose hall

pin microphone



2 units/Panasonic WX-ST400
Multipurpose hall

LED spotlight



1 set/L-PAR-7
Multipurpose hall

Light control console



1 machine/PRELUCE
2i multipurpose hall

floor curing sheet



1 set/Multi-purpose seat for full-face shoes,
Multi-purpose hall

Green sheet for shoes



3-sheet size 140x1500
multipurpose hall

Horizontal signboard frame



1 unit/W500xH60 multipurpose hall

hanging baton

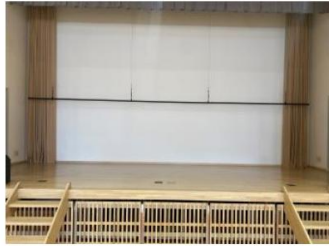

1 piece/W900/load capacity 200kg Multipurpose hall

Entrance mat for shoes



5 sheets/size 90x300 Multipurpose hall

Tabletop microphone stand Floor-mounted microphone stand



5 machines/operating range 30cm to 50cm Multipurpose hall



2 machines/operating range 90cm to 150cm Multipurpose hall

3-tier foldable aluminum stand



1 set/Can be connected individually Multipurpose hall

hdmi transceiver



1 unit Used to send projection data from inside the hall to the control room Multipurpose hall

L-shaped stand



15 units/H130cm to 240cm

belt partition



10 units/can be connected, maximum 240 cm per unit

Standing signboard frame



2 sides/Overall W50xH190 White side W50xH160 Multipurpose hall

Other rental equipment	Number	Specifications/Standards
HDMI cord	3 pieces	5m x 2/30m x 1
RGB code	Two	Dsub15pin
run cable	Two	5m x 1/50m x 1
power extension cord	3 pieces	3m x 1/5m x 1/10m x 1
drum cord	1 piece	Can be used indoors and outdoors/Length 30m/Thickness 1,25m
HDMI to S terminal converter	1 piece	50(cm)
blue sheet	Three	360x540(cm)
intercom set	8 units	microphone wired
laser pointer	2 units	ELP-GL09BK laser color green
Black Bon (Award Bon)	2 units	W60xD40 (cm)
Whiteboard marker set 2 sets		Black pen/Red pen/Blue pen/Eraser

Multipurpose hall theater layout plan

Approximately 1/100

• 2 seats x 5 tables x 16 rows (160 people) layout (draft)

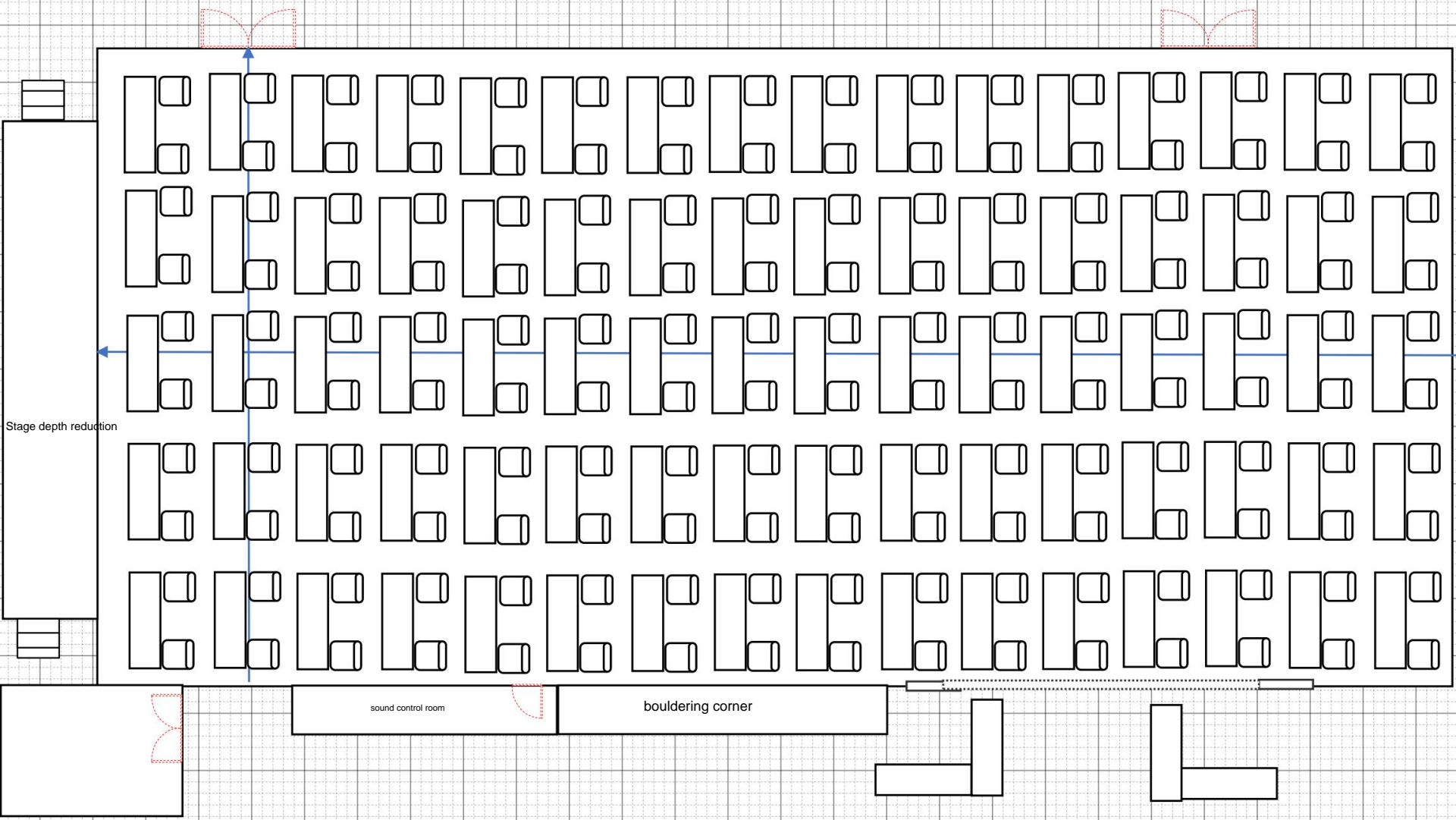

Multipurpose hall theater layout example

Approximately 1/100

•10 chairs x 20 rows (200 people) layout example

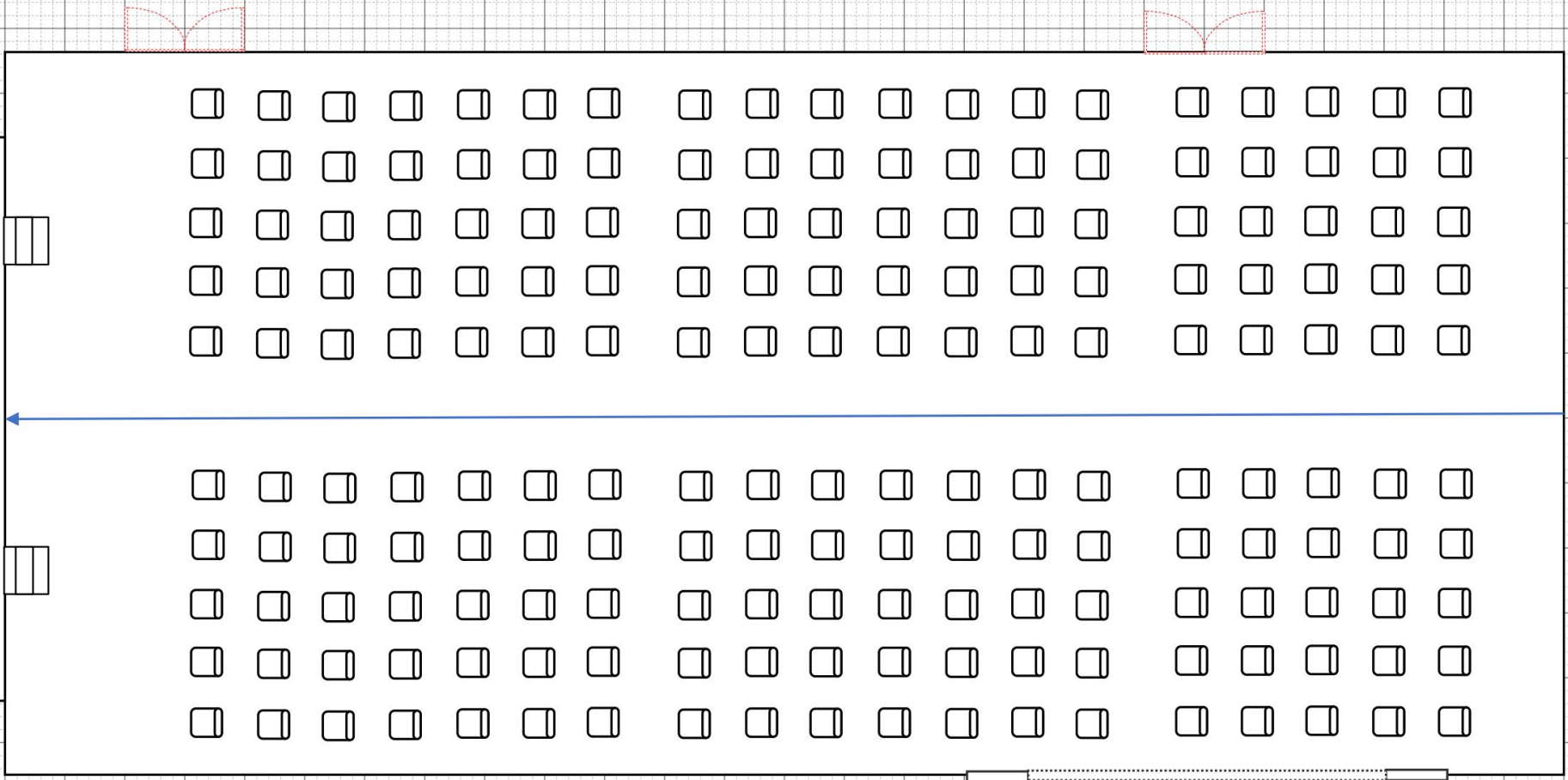

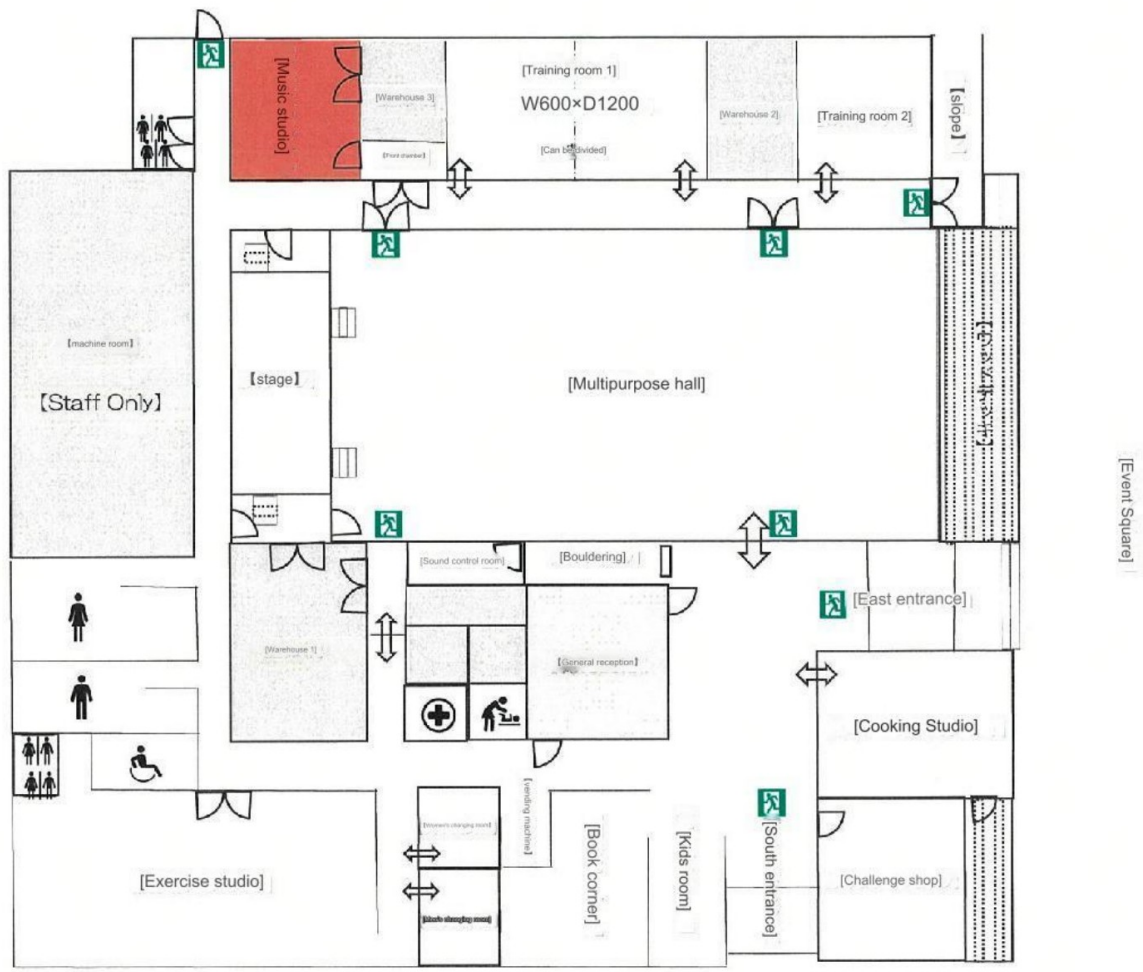

Okuma Town Exchange Facility link Ru Okuma

1207-1 Nandaira, Okawara, Okuma-machi, Futaba-gun, Fukushima 979-1306 TEL 0240-23-7676



<https://goo.gl/maps/UmENecisJkq4Cvti9>

音楽スタジオ

Music studio [Maximum

capacity] 7 people

[Area]

【面積】

約36㎡

【備考】

Approximately

36y [Notes]

No food, drinks allowed

Karaoke set available. (Separate cost will be charged.)

Amplifier



EDN/EC15

drum set



PEARL/MDT764P/C

Electronic piano



YAMAHA/MX-88

Amplifier



Roland JC-120G

Amplifier



Marshall/Code 100

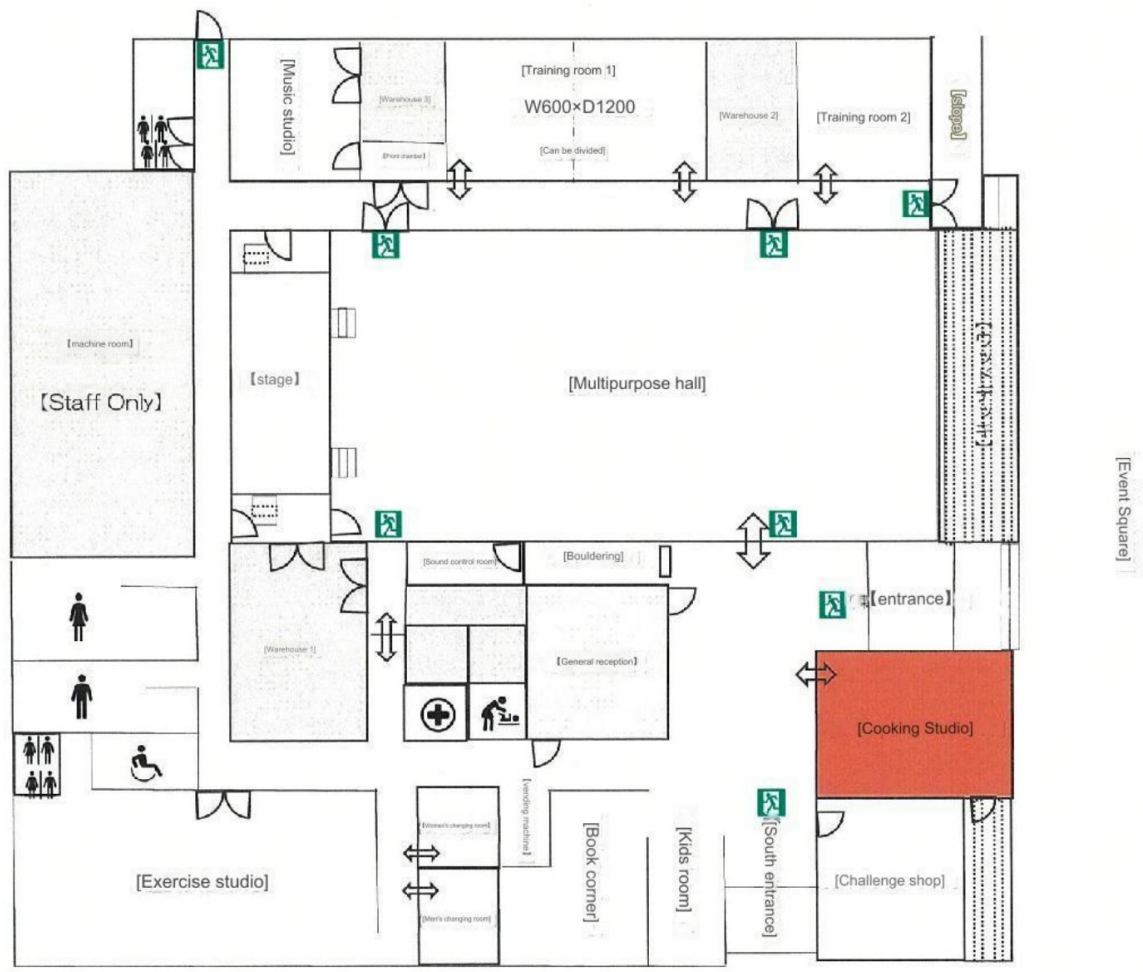

Okuma Town Exchange Facility link Ru Okuma

1207-1 Nandaira, Okawara, Okuma-machi, Futaba-gun, Fukushima 979-1306 TEL 0240-23-7676



<https://goo.gl/maps/5BJDjQqDP1wCGkVr8>

cooking studio

[Maximum

capacity]

18

people

[Area] 57ŷ

[Notes] No shoes allowed (slippers required) Cooking table 5 tables

•A variety of cooking utensils and utensils available

Only the ingredients are prepared.

If you have it, I can cook and eat it.

Possible.

Instructor with monitor equipment

Display the situation at the table on the monitor.

can you bring it out

, cooking classes and cooking training

Please use it for other purposes.



Cooking Studio Cookware List

gas fast oven
DR-320



rice cooker
SR-VSX181



oven range
NE-BS808



electric pod
NC-SU224



Gas stove
DG32T1V



Hot plate



refrigerator
NR-C342GCL-T



mixer
MX-X701



food processor
DLC-10



Rental cooking utensils	Number of pieces	Rental cooking utensils	Number of pieces
Pasta pot (pasta pot)	5 pieces	Tea strainer	5 pieces
Tempura pot (deep frying pot)	5 pieces	tongs	Ten
kettle	5 pieces	fly returner	5 pieces
frying pan	5 sheets	Tempura scraps	5 pieces
Tamagoyaki pot (tamagoyaki pot)	5 sheets	Whisk (large)	5 pieces
one-handed pot	5 pieces	peeler	Five
hand mixer	5 pieces	can opener	Five
Whisk (small)	5 pieces	masher	5 pieces
Rice scoop	5 pieces	kitchen shears	5 guns
lightweight spoon	5 pieces	measuring cup	5 pieces

Rental cooking utensils	Number of pieces	Rental cooking utensils	Number of pieces
Square bat net	5 pieces	Colander (large to very small)	5 each one by one
bat	5 pieces	mittens	5 pairs
Ladle (large)	5 pieces	scale	5 pieces
Ladle (small)	5 pieces	glass cup	23 pieces
Ladle (perforated)	5 pieces	Coffee cup	20 pieces
Ladle (large)	5 pieces	coffee plate	20 pieces
Ladle (small)	5 pieces	small plate	20 dishes
steamer	5 units	small bowl	19 dishes
Two-handed pot (Teflon) (Practical pot)	5 pieces	Bowl	23 pieces
Two-handed pot (stainless steel) (Practical pot)	5 pieces	soup bowl	24 pieces

Rental cooking utensils	Number of pieces	Rental cooking utensils	Number of pieces
flat plate	20 dishes	Wooden spoon (large)	5 pieces
curry plate	25 dishes	Wooden spoon (small)	5 pieces
vessel (deeper)	20 dishes	cutting board	10 pieces
rolling pin	5 pieces	chopsticks	9 meals
mortar stick	5 pieces	chopsticks	20 meals
roll	5 pieces	Fork (small)	20 pieces
grater plate	5 pieces	Spoon (small)	18 pieces
mortar	5 pieces	Fork (large)	31 pieces
knife	20 guns	Spoon (large)	25 pieces
petty knife	5 pieces	table knife	20 pieces

Rental cooking utensils	Number of pieces	Rental cooking utensils	Number of pieces
cookie cutter (Vegetables can be cut out)	5 sets (6 types)	rubber spatula	5 pieces
pudding type	20 pieces	scale removal	5 pieces
center thermometer	4 pieces	timer (Kitchen timer) Glass bowl	5 units
bread knife (Baba knife)	5 pieces	(dessert cup)	18 pieces
Bowl (large to extra small)	5 pieces each	wooden long tray	4 pieces
salad bowl	20 pieces	Shallow bowl (black)	20 sheets

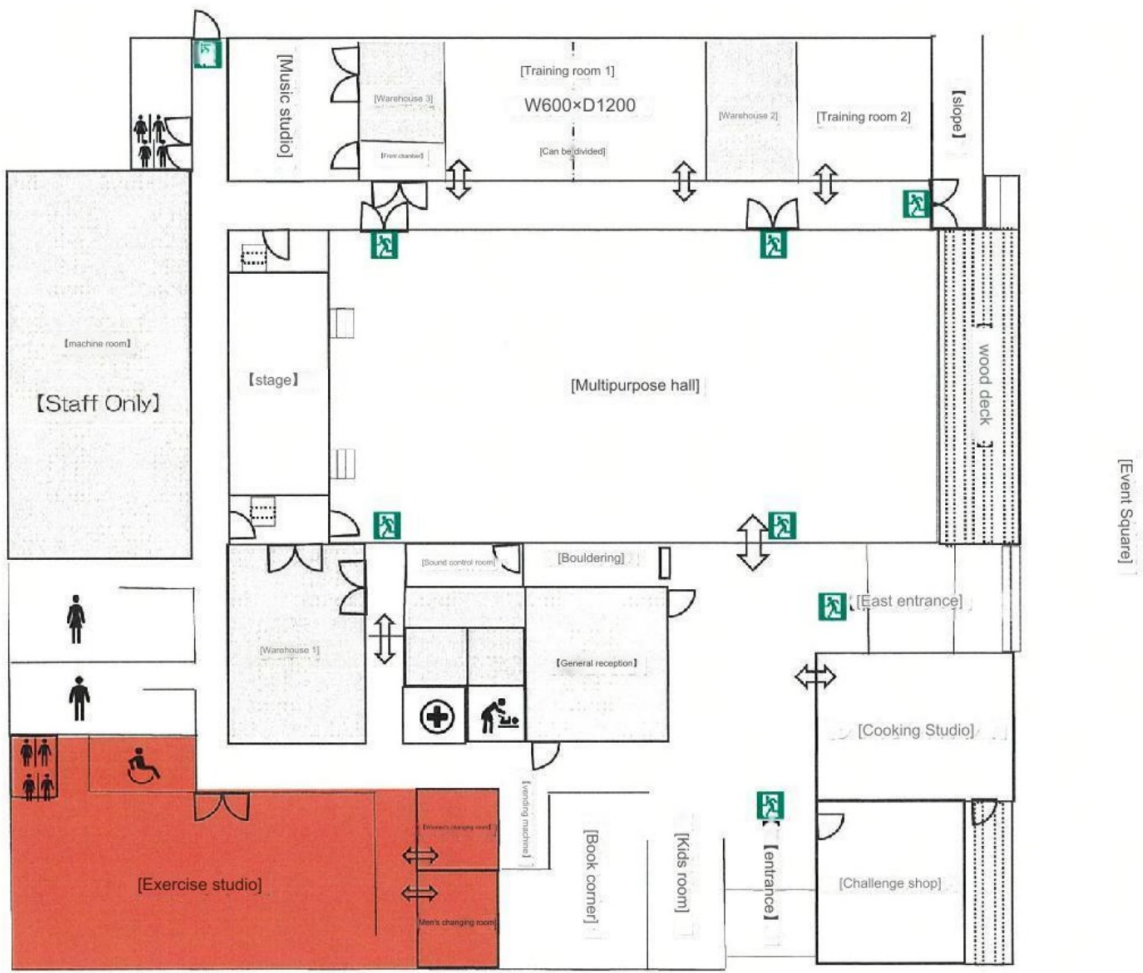

Okuma Town Exchange Facility link Ru Okuma

1207-1 Nandaira, Okawara, Okuma-machi, Futaba-gun, Fukushima 979-1306 TEL 0240-23-7676



<https://goo.gl/maps/MyhPMeZntbBHPvTA>

運動スタジオ exercise studio

[Maximum

capacity]

18 people

[Area]

Approximately

138 m2 [Notes] No shoes allowed (please bring indoor shoes)

Admission fee: Free

Annual fee: Free Locker room and shower room available

Inbody (body composition analyzer) available

- We are the first in the prefecture to introduce the latest training machines that were also used in the Tokyo Olympics athletes' village.
- You can also check your training results using InBody (body composition analyzer) .•Aim to build your ideal body by increasing muscle strength, increasing stamina, dieting, etc.

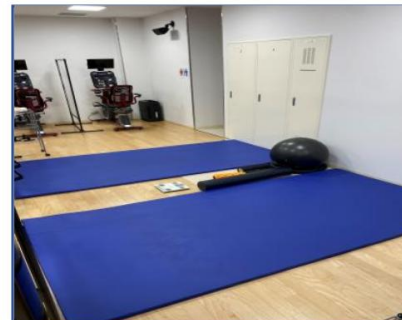
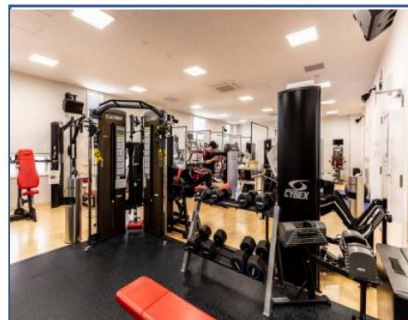

exercise studio training equipment

freedom rack



leg press



Seeded Leg Curl Torso Rotation

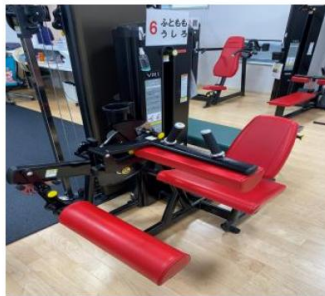

Abdominal/
back extension



upright bike



free runner



arc trainer



lat pull/row



chest press



overhead press recumbent bike



bravo

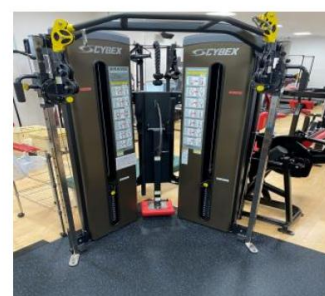

trail hiker

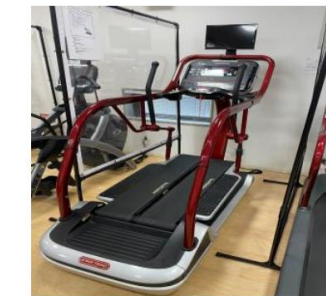

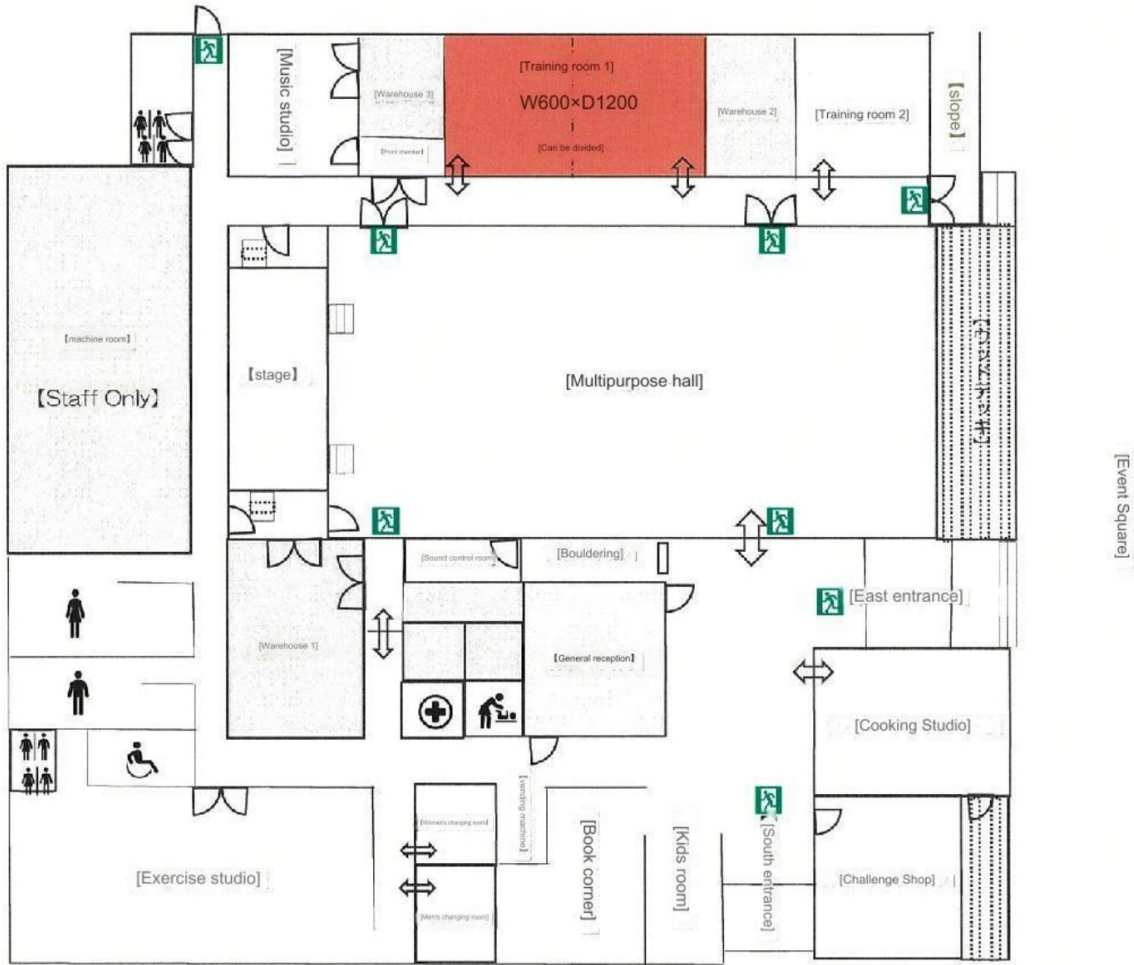

Okuma Town Exchange Facility link Ru Okuma

1207-1 Nandaira, Okawara, Okuma-machi, Futaba-gun, Fukushima 979-1306 TEL 0240-23-7676



<https://goo.gl/maps/cvWfKjD3vKqUdS49>

研修室 1

Training room 1

[Maximum capacity]

32

people [Dimensions/

Interview] Normal time

W600 x D1200

Approximately 72 \bar{y} when divided

W600 x D600

Approximately 36 \bar{y} (2 rooms)

[Notes]

Eating and

drinking allowed

Separate use available (please contact us in advance) School format is the initial arrangement (2 seats x 14 tables) - Customers can change the layout of chairs and tables. Yes, it is possible. (However, please return to the current state within the rental time.) - Equipped with microphones, CDs, Blu-rays, sound equipment, projectors, etc. It can be used for training sessions, seminars, lectures, etc.

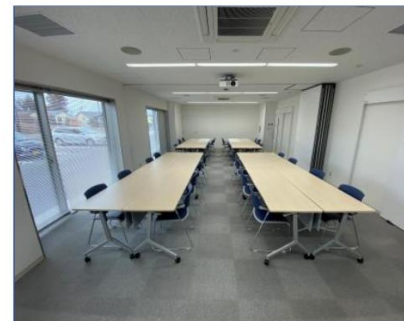
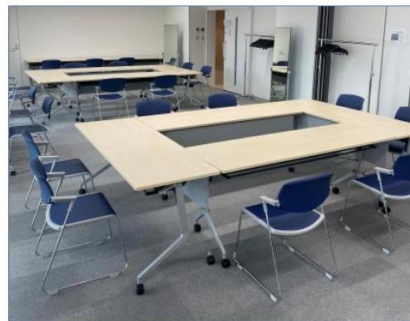
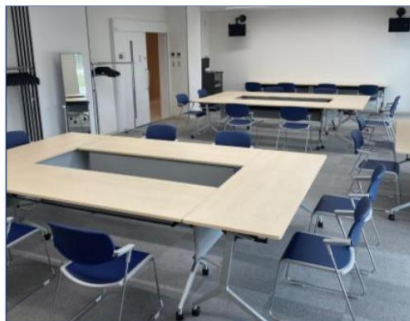

DLP projector



1 unit/Panasonic
PT-VMZ60/6.000ml

sound system



1 unit/playback medium (Blu-ray
/DVD/CD/SD/USB)

hanger rack



3 units/1 hanger rack 10
hangers

L-shaped stand



15 units/H130cm to 240cm

side fold table



14 legs/with curtain plate
W180xD60xH70

conference room chairs



42 chairs in total
28 chairs (1 training room already placed) 14
chairs remaining (in the warehouse)

full-length mirror



3 units/mirror surface W45x155

Whiteboard



4 units/Whole W180xH190
Entry section W180xH90

wireless microphone



2 units/Panasonic
WX-ST200

Training room 1 layout diagram

•2 seats x 4 tables x 7 rows (28 people) Initial layout

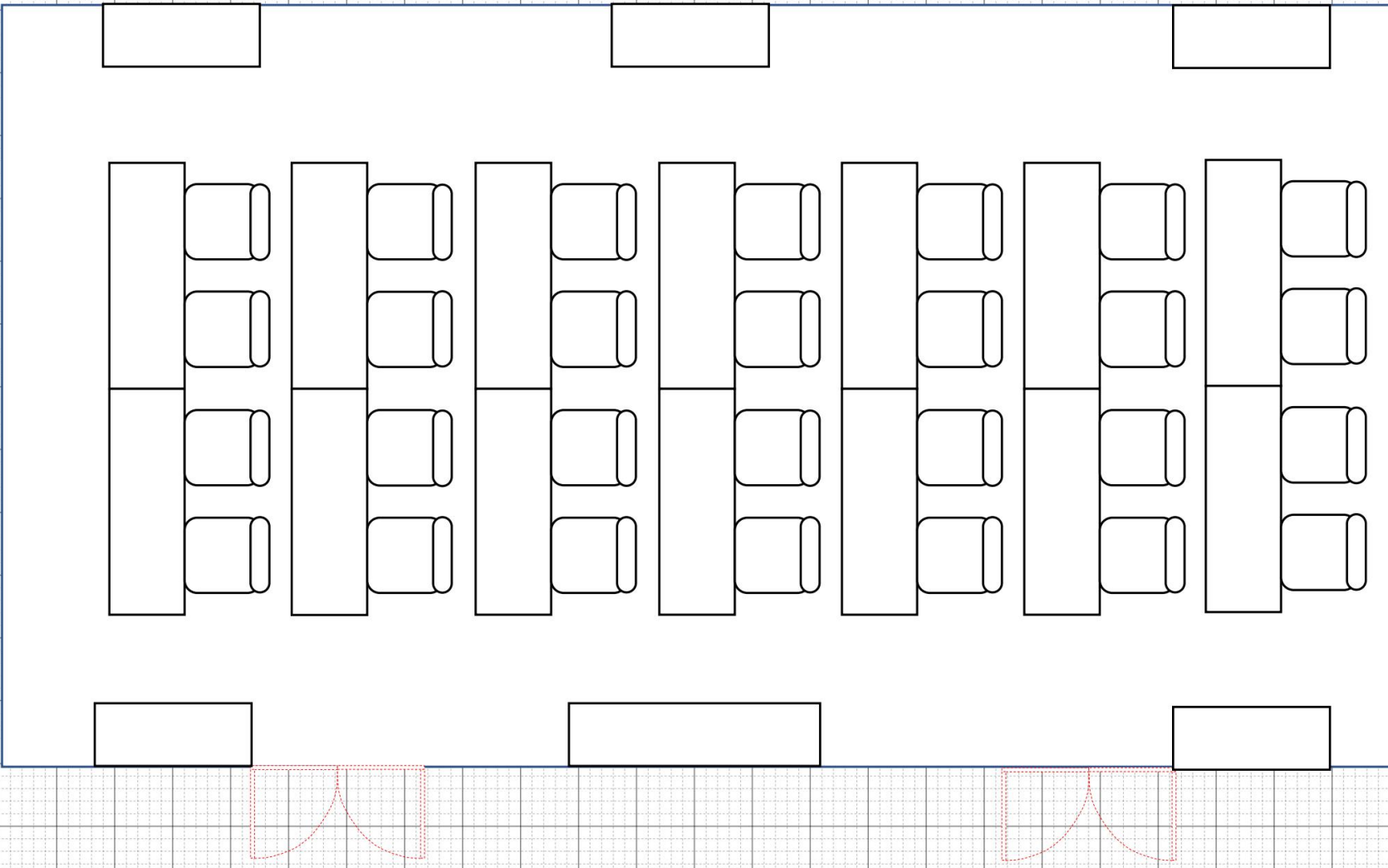

Training room 1 layout diagram

- 2 seats x 5 tables = 10 people
- 8 seats x 2 = 16 people Total 26 people

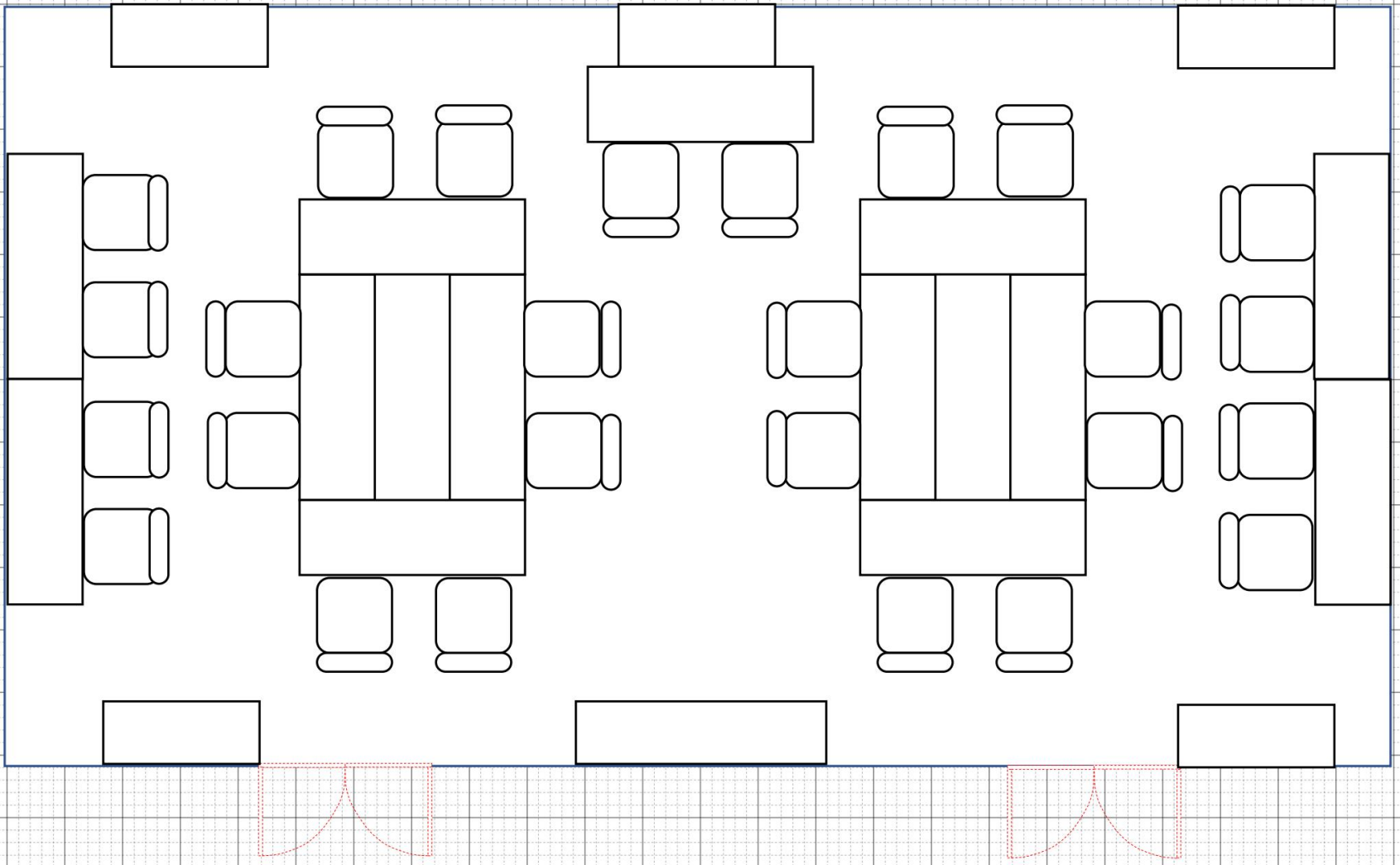

Training room 1 layout diagram

•Island for 8 people x 4 = 32 people Total 32 people

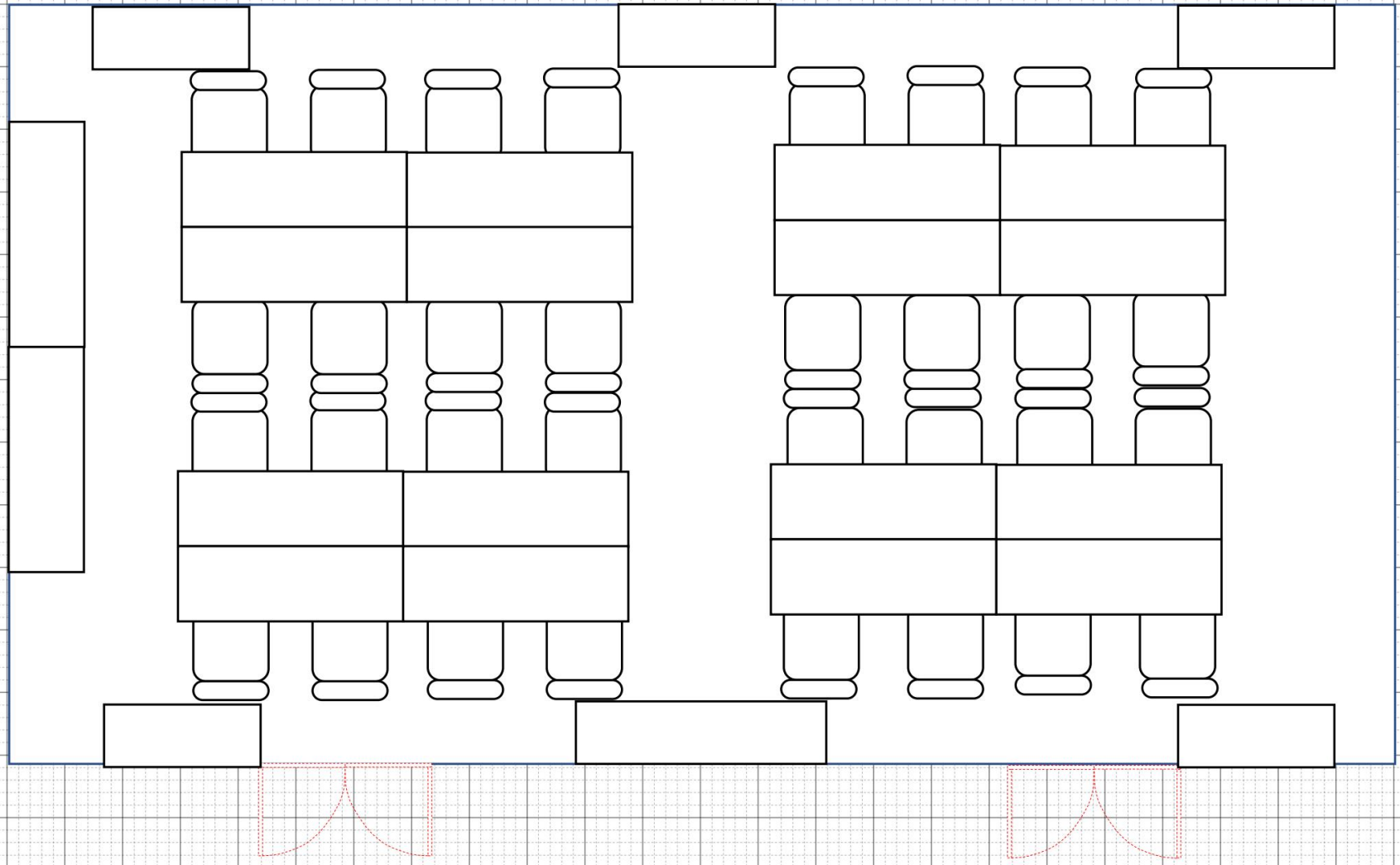

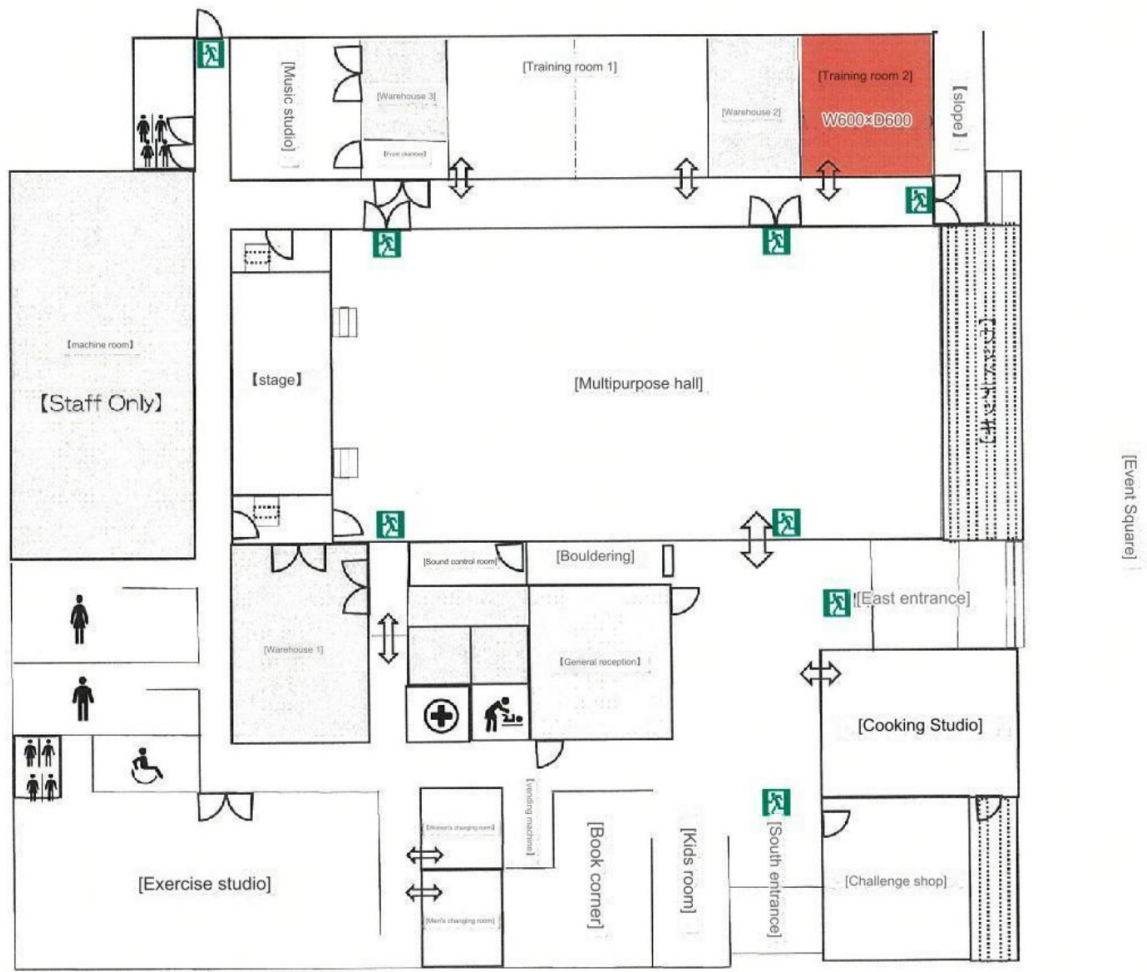

Okuma Town Exchange Facility link Ru Okuma

1207-1 Nandaira, Okawara, Okuma-machi, Futaba-gun, Fukushima 979-1306 TEL 0240-23-7676



<https://goo.gl/maps/yb6bSSLDANzmGMfu7>

Training room 2

[Maximum capacity]

10

people [Dimensions/area]

W600xD600 Approx. 36

ÿ [Note]

Eating and
drinking allowed

•This training room is suitable for round-table seminars, lectures, meetings, etc. It is fully equipped with equipment such as microphones, music CDs, Blu-rays, and projectors . We also have play equipment such as mahjong sets, shogi, and Go, so you can use it as a place to socialize with your family and



Fully automatic mahjong table

2 units/AmosJPÿ

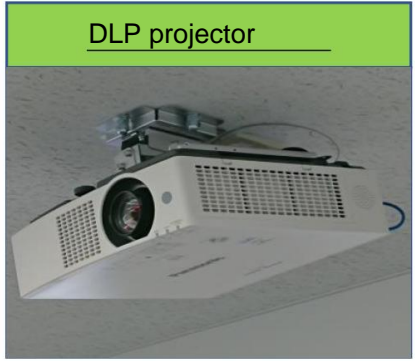

DLP projector

1 unit/Panasonic/
PT-VMZ60/6.000ml



sound system

1 unit/playback
medium (Blu-ray/DVD/CD/SD/USB)



Whiteboard

4 units/Whole W180xH190
Entry section W180xH90

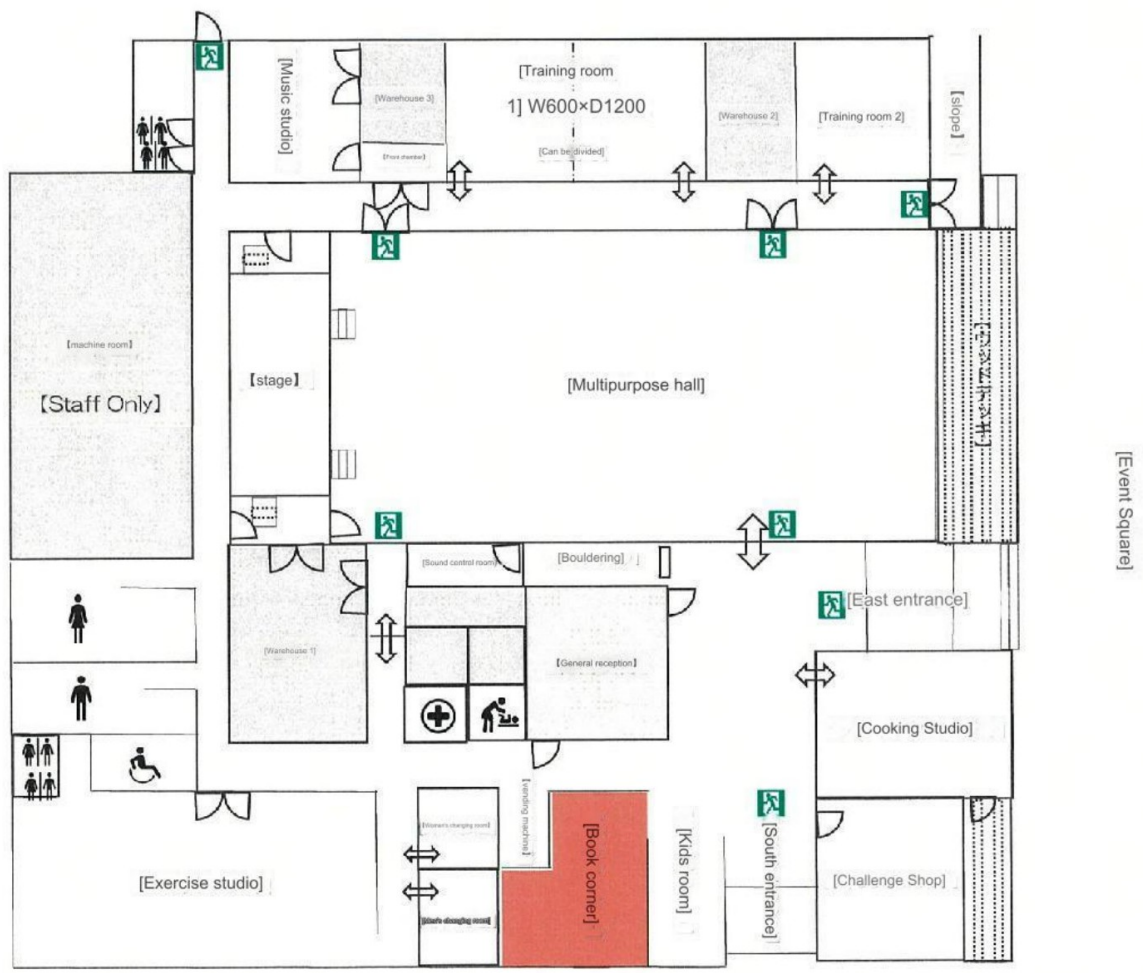

Okuma Town Exchange Facility link Ru Okuma

1207-1 Nandaira, Okawara, Okuma-machi, Futaba-gun, Fukushima 979-1306 TEL 0240-23-7676



図書コーナー [Area]

【面積】

約43

【備考】

食事不可

飲み物可

Approximately

43y [Notes] No food allowed,

•A library where you can browse books for the purpose of reading, research, and research. •Local newspapers are also available. •Please note that as a general rule, we do not lend out items. •We also have power supplies and Wi-Fi in the building, so you can bring your own PC with you. •We also rent chargers. •If you wish to use the service, please inquire at the reception desk.



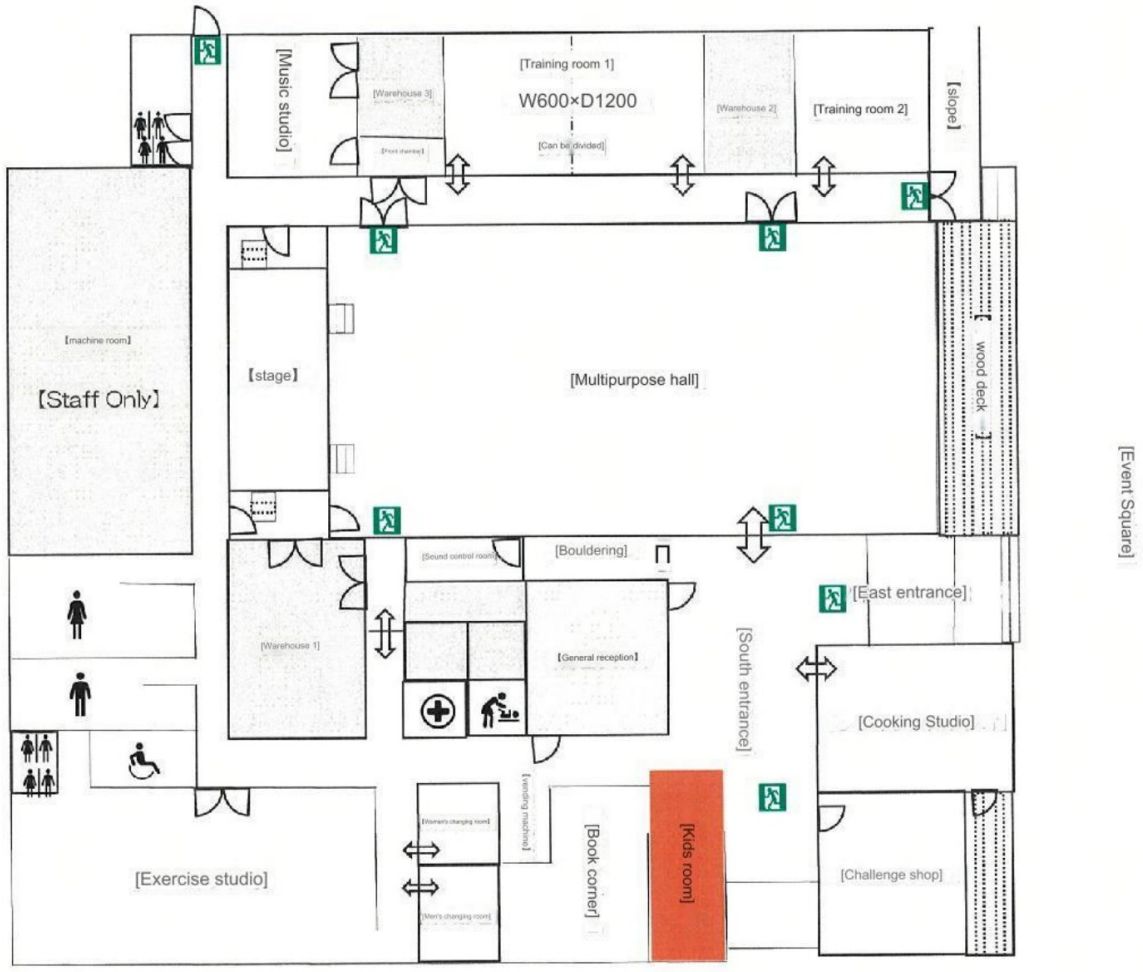

Okuma Town Exchange Facility link Ru Okuma

1207-1 Nandaira, Okawara, Okuma-machi, Futaba-gun, Fukushima 979-1306 TEL 0240-23-7676



Kids room [Area] △

【面積】

約20

Approximately 20y [Notes]

飲食不可

Free usage fee

要受付

- Cleanliness for small children that parents and children can enjoy together

Overflowing kids room.

- We have picture books and toys ready for you to play with.

vinegar.

- We also have a nursing room, so if you would like to use it, please contact the general reception desk.

Please let us know.



Okuma Town Exchange Facility link Ru Okuma

1207-1 Nandaira, Okawara, Okuma-machi, Futaba-gun, Fukushima 979-1306 TEL 0240-23-7676



Event plaza 広場 [dimensions/area]

W2000xD4000

Approximately

800y [Note]

事前に要予約

- You can exclusively use the entire Link Okuma facility and the adjacent event plaza. link Okuma Indoor Wood
A deck is also available for use.

*For commercial purposes, the fee will be increased by 150% of the displayed price . Please

contact us for details. •For reservations, please call or use the inquiry form.



[Okuma Town Exchange Facility link Ru Okuma Multipurpose Hall Construction Price List]

yCuring sheet installation/removal fee

Full-scale installation ¥55,000 (tax included)

only *Set-up/removal time...Set-up 2 hours/Removal 2 hours

yChair and table installation/removal

100 users or more *Set- ¥44,000 (tax included)

up/teardown time...Set-up 2 hours/Tear down 2 hours

Less than 100 users *Set- ¥33,000 (tax included)

up/teardown time...Set-up 1h/Tear down 1h

<Notes>

As a general rule, we ask the users of the venue to set up and tear down the venue. Introducing vendors

However, if it is still difficult, please consult us after understanding the above charges.

Please.

Revised 2022/11/14

Okuma Town Exchange Zone Designated Manager

Sun Amenity Co., Ltd.

町役場方面

常磐道方面



注意事項

note: Parking is limited. If you are using "Link Okuma" or "Hotto Okuma", please park at "P2", "P3", or "P4".

If you are coming by a large vehicle such as a chartered bus, please use "P4". Please contact us in advance. Colored cones will be installed in the bus space to secure enough space for the number of buses.