



<https://goo.gl/maps/cvWfKp3vRkqUdS49>

研修室 1

Training room 1

[Maximum capacity]

32

people [Dimensions/

Interview] Normal time

W600 x D1200

Approximately 72y when divided

W600 x D600

Approximately 36y (2 rooms)

[Notes]

Eating and

drinking allowed

Separate use available (please contact us in advance) School format is the initial

layout (2 seats x 14 tables) - Customers can change the layout of chairs and tables.

Yes, it is possible. (However, please return to the current state within the rental time.) -

Equipped with microphones, CDs, Blu-rays, sound equipment, projectors, etc. It can

be

used for training sessions, seminars, lectures, etc.



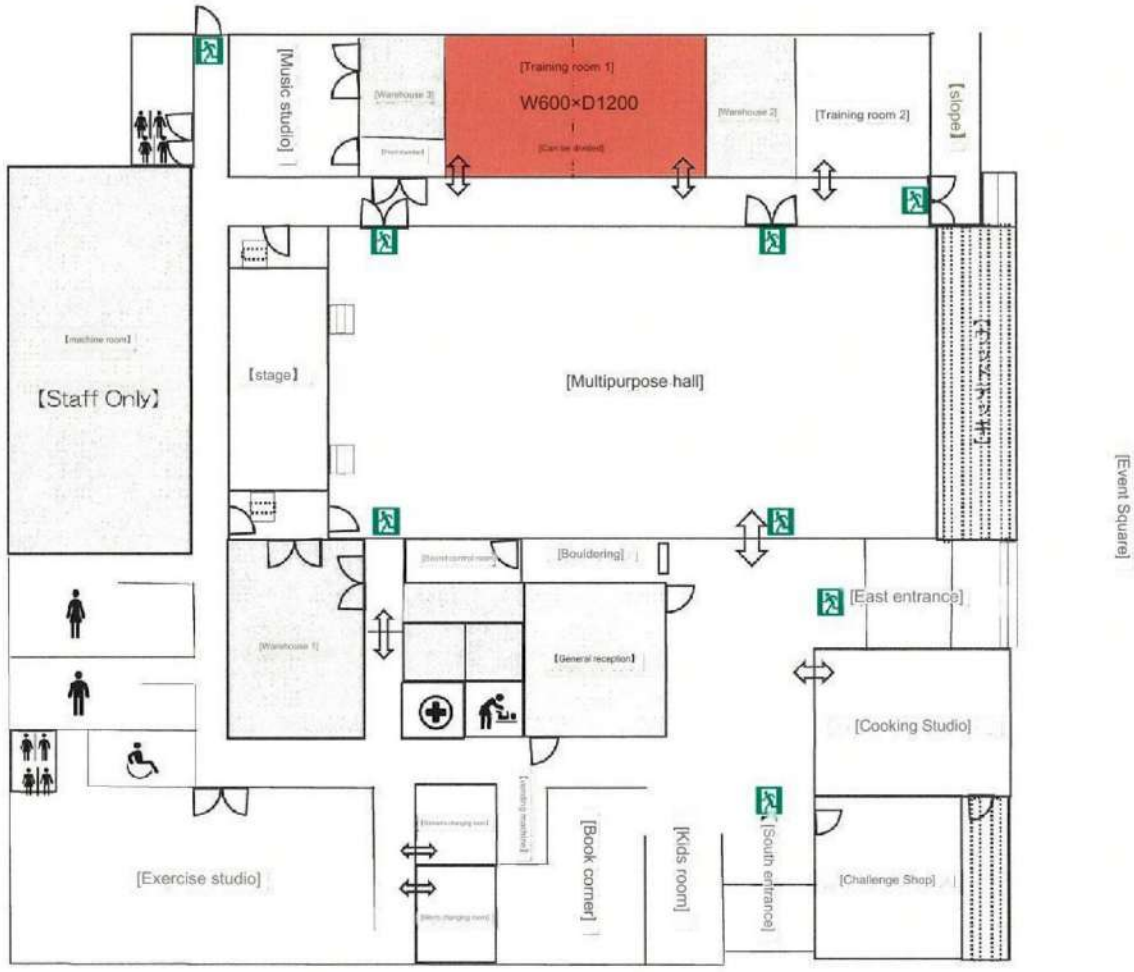

Okuma Town Exchange Facility link Ru Okuma

1207-1 Nandaira, Okawara, Okuma-machi, Futaba-gun, Fukushima 979-1306 TEL 0240-23-7676

DLP projector



1 unit/Panasonic
PT-VMZ60/6.000ml

sound system



1 unit/playback medium (Blu-ray
/DVD/CD/SD/USB)

hanger rack



3 units/1 hanger rack 10
hangers

L-shaped stand



15 units/H130cm-240cm

side fold table



14 legs/with curtain plate
W180xD60xH70

conference room chairs



42 chairs in total
28 chairs (1 training room already placed) 14
chairs remaining (in the warehouse)

full-length mirror



3 units/mirror surface W45x155

Whiteboard



4 units/Whole W180xH190
Entry section W180xH90

wireless microphone



2 units/Panasonic
WX-ST200

Training room 1 layout diagram

•2 seats x 4 tables x 7 rows (28 people) Initial layout



Training room 1 layout diagram

- 2 seats x 5 tables = 10 people
- 8 seats x 2 = 16 people Total 26 people

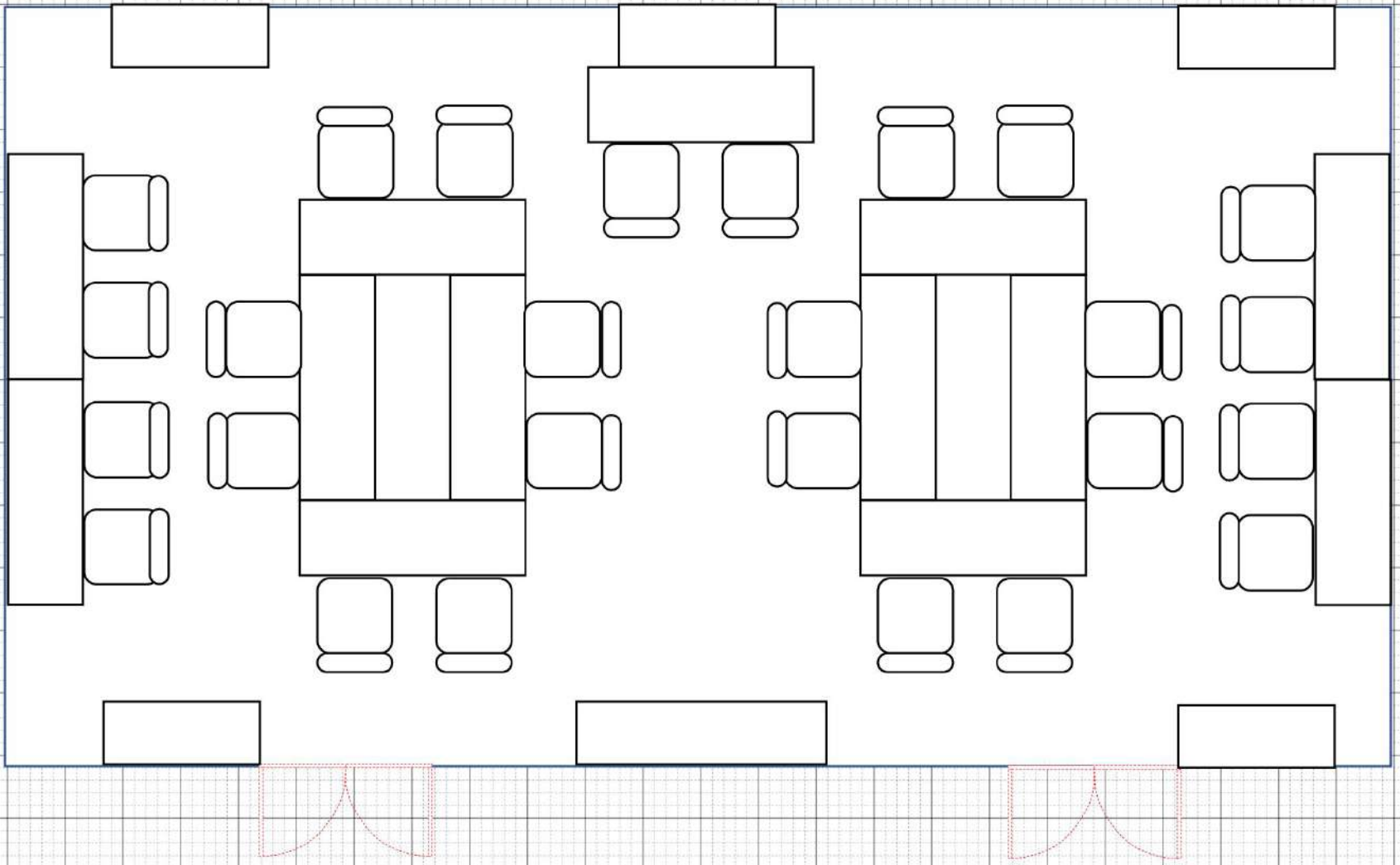

Training room 1 layout diagram

•Island for 8 people x 4 = 32 people Total 32 people

